



## Replacement

### **CAUTION**

Put on gloves to protect your hands.

### **Information**

- Use a plastic panel removal tool to remove interior trim pieces without marring the surface.
- Be careful not to bend or scratch the trim and panels.

### [SBW type]

1. Remove the console upper cover (A) by using a remover.

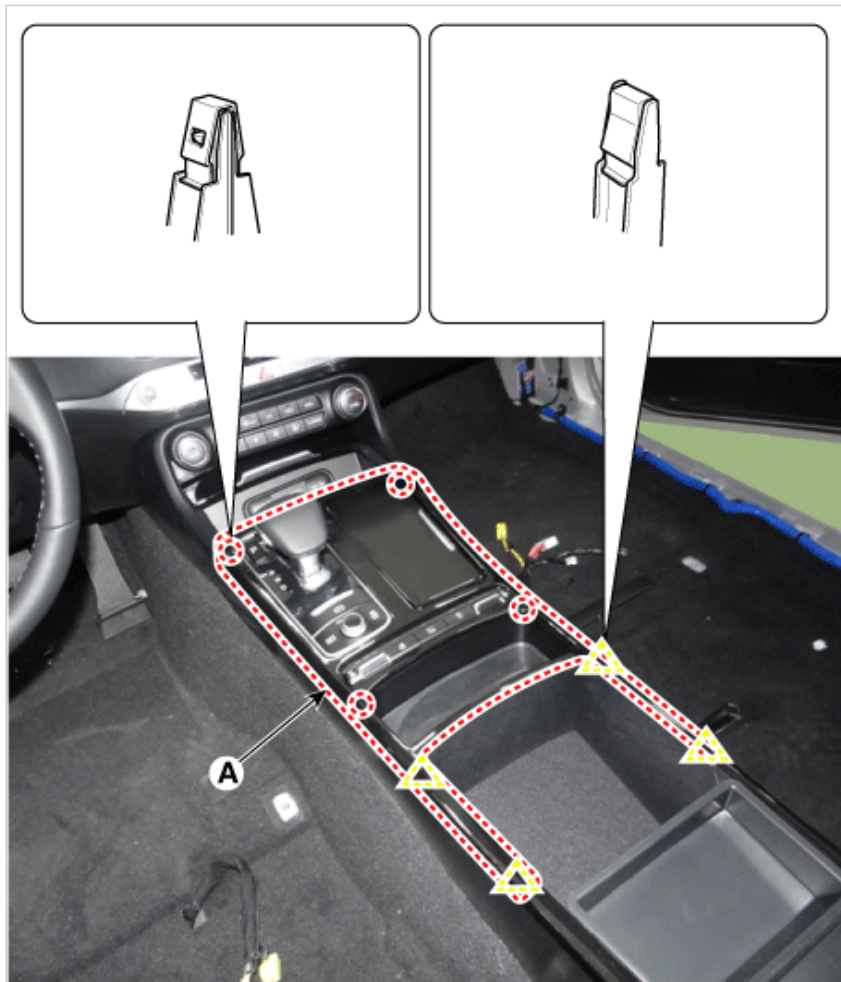

2. Remove the console upper cover after disconnecting the console upper cover connectors (A).



3. Remove the console storage box small tray (A).



4. Remove the console storage box mat (A).



5. Remove the console side molding (A).

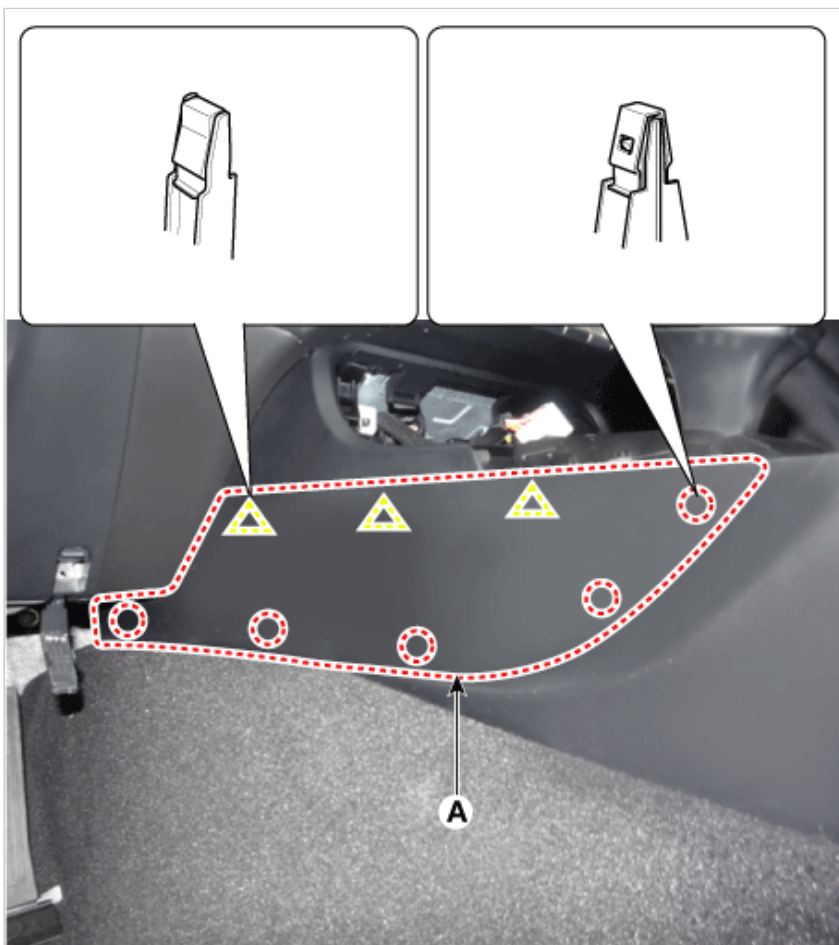

6. Loosen the mounting bolts (A).





7. Loosen the console mounting bolts.



8. Disconnect the console upper side extension connectors (A).

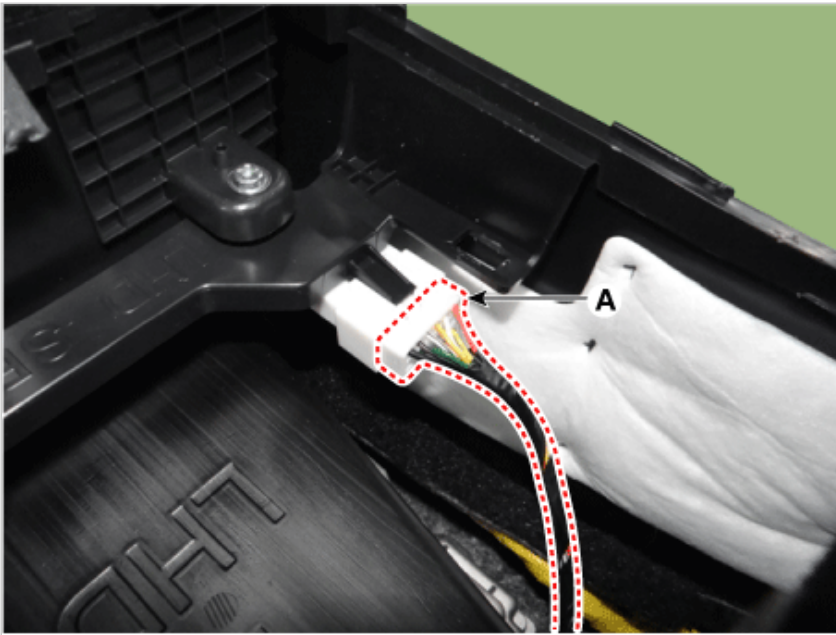

9. Disconnect the electronic shift lever connector (A).



10. Disconnect the console lower side extension connectors (A).

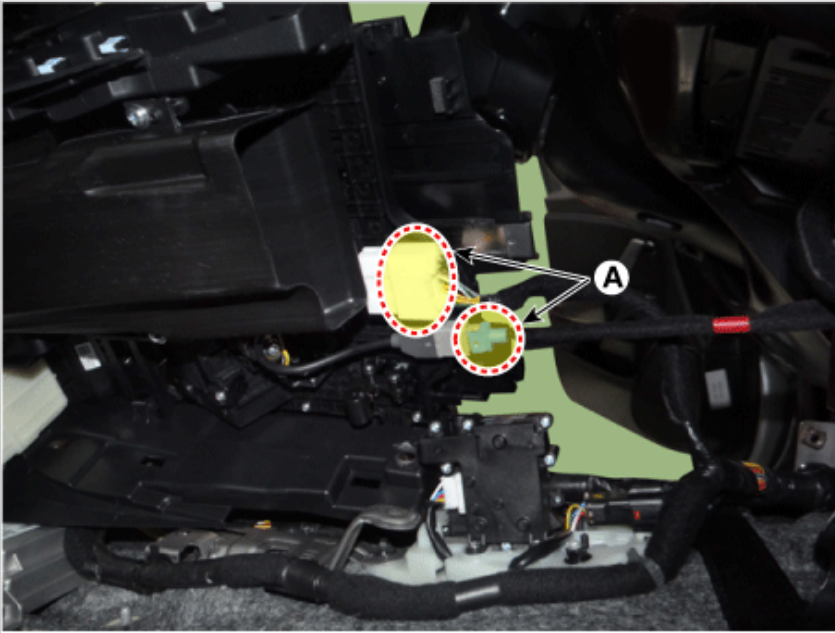

11. Remove the heater control unit after disconnecting the connector (A).



12. Remove the console front cover (A) after loosening the mounting screws.



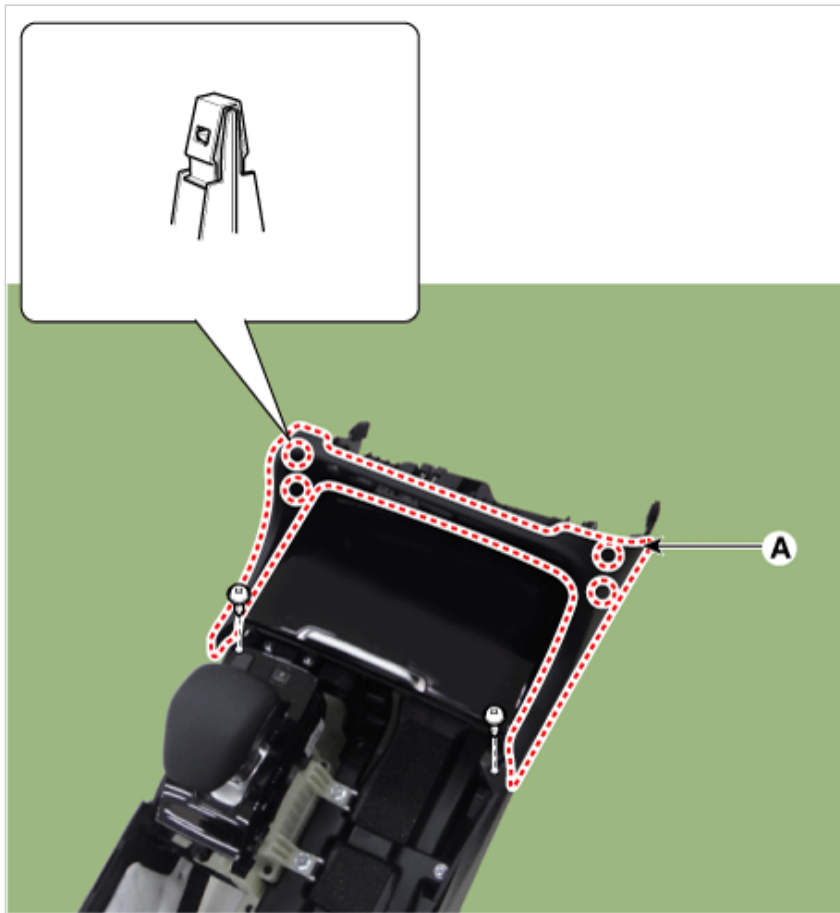

13. Separate the heater control unit (A).

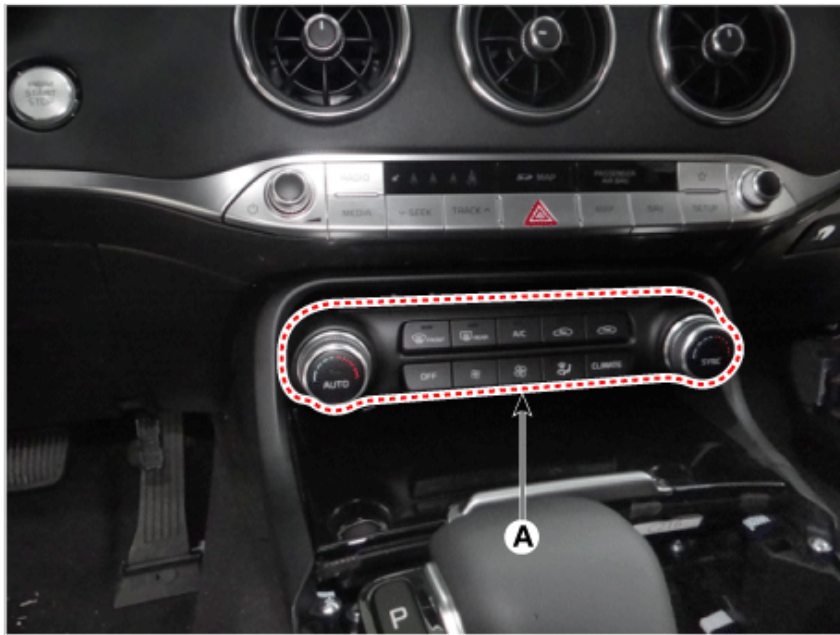

14. Remove the console tray(A) by using a remover.

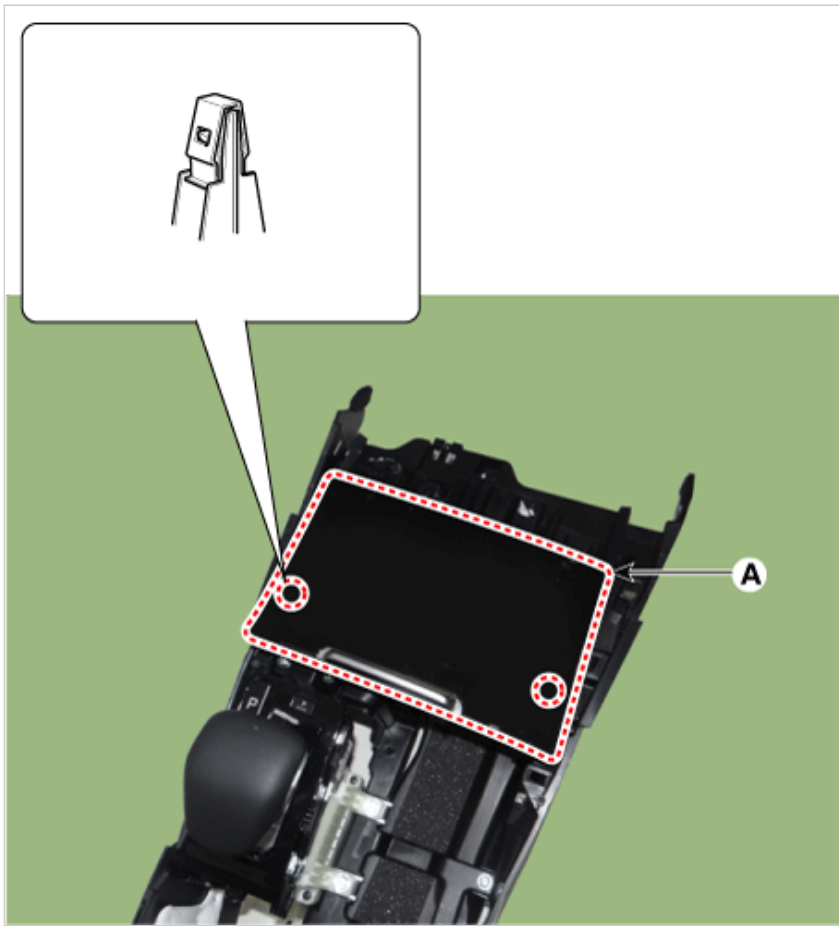

15. Remove the electronic shift lever (A) after loosening the mounting bolts & screws.

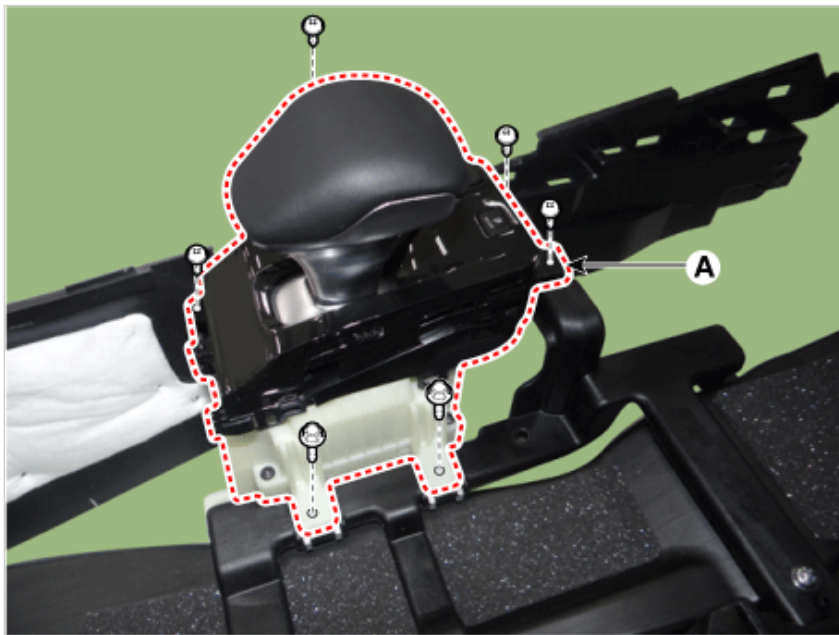

16. Remove the console assembly (A).





17. Install in the reverse order of removal.

**i Information**

- Make sure the connector is connected properly.
- Replace any damaged clips.